

FOR LEASE

MOSLER LOFTS

2720 3rd Ave., Suite CU1, Seattle, WA 98121



COMMERCIAL CONDOS

COMMERCIAL UNIT 1 - 1,926 SF

- Operating Bank – Available October 1, 2020
- LEED Silver construction.
- 2 privates, vault and break rooms, bathroom and open work area.
- One block from the Seattle Center

2019 Demographics		
Mosler Lofts Retail	.25 Mile	.5 Mile
Population	9,333	25,704
Households	6,088	16,475
Average HH Income	\$122,334	\$111,704
Median HH Income	\$787,583	\$763,842

RICK PARKS

rickparks@trfpac.com

Office: 206-985-0107

Cell: 206-369-5770

TRF PACIFIC, LLC

2620 Second Avenue,

Seattle, WA 98121

P: 206-985-0100

F: 206-985-0102

info@trfpac.com

Managed by:



PACIFIC

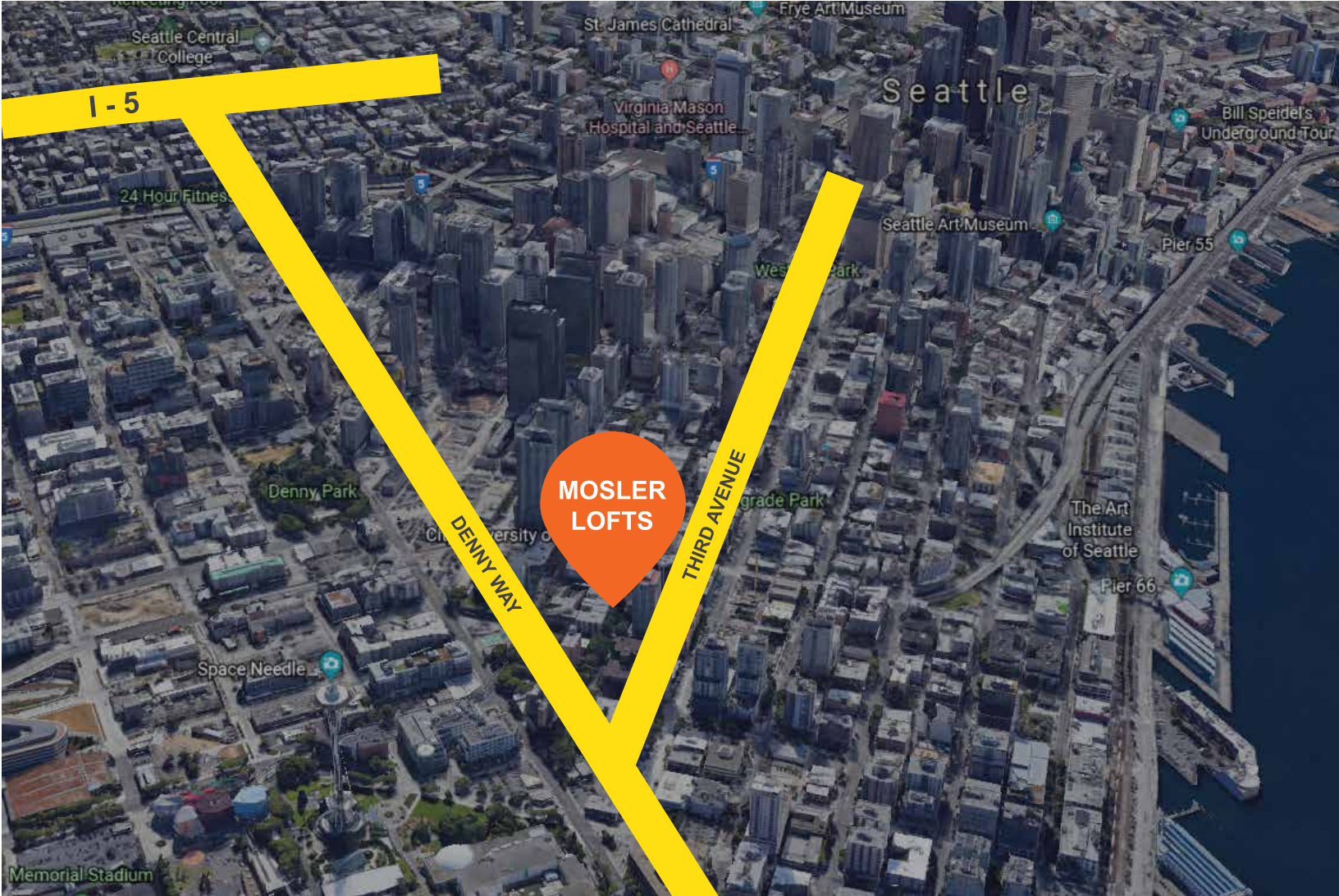

LEASE PLAN

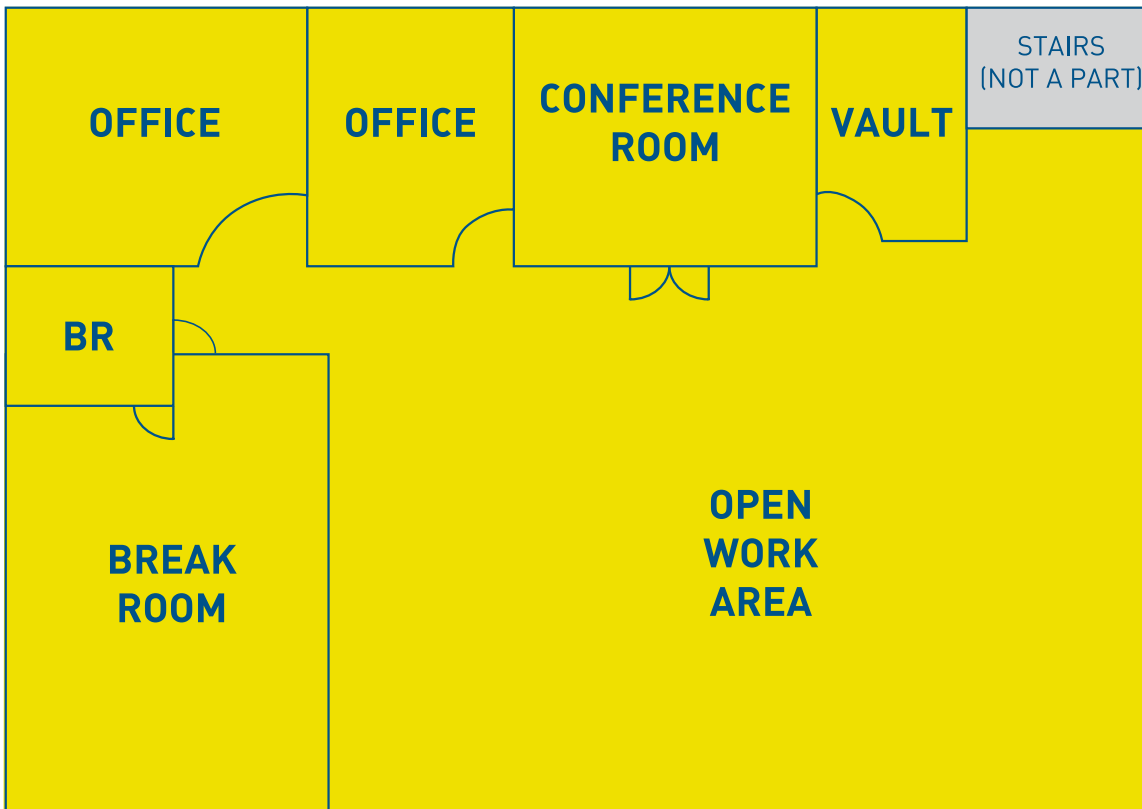

RICK PARKS

rickparks@trfpac.com

Office: 206-985-0107

Cell: 206-369-5770

TRF PACIFIC, LLC

2620 Second Avenue,

Seattle, WA 98121

P: 206-985-0100

F: 206-985-0102

info@trfpac.com

Managed by:



PACIFIC